

This manual is for reference and historical purposes, all rights reserved.

**This page is copyright© by M. Butkus, NJ.**

This page may not be sold or distributed without the expressed permission of the producer

I have no connection with any camera company

On-line camera manual library

This is the full text and images from the manual. This may take 3 full minutes for the PDF file to download.

**If you find this manual useful, how about a donation of \$3 to: M. Butkus, 29 Lake Ave., High Bridge, NJ 08829-1701 and send your e-mail address so I can thank you. Most other places would charge you \$7.50 for a electronic copy or \$18.00 for a hard to read Xerox copy.**

**This will allow me to continue to buy new manuals and pay their shipping costs.**

**It'll make you feel better, won't it?**

**If you use Pay Pal or wish to use your credit card,  
click on the secure site on my main page.**

E G F S P

[www.orphancameras.com](http://www.orphancameras.com)

**OLYMPUS**  
***PEN EF***

**INSTRUCTIONS**



**1.**

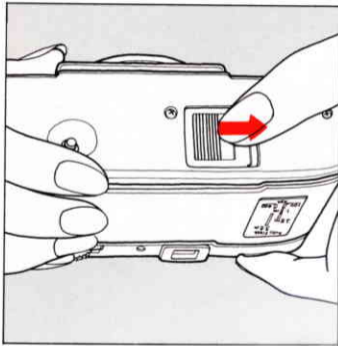

**2.**

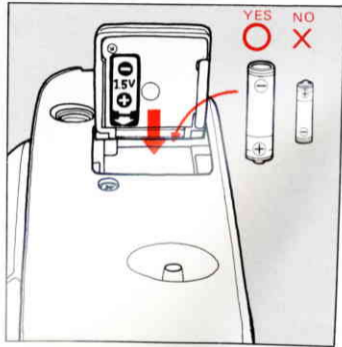

3.

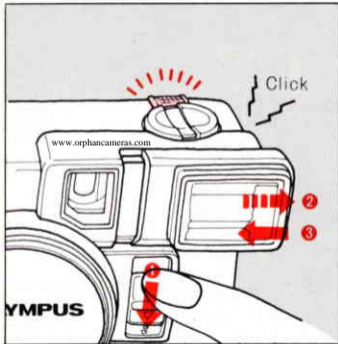

4.

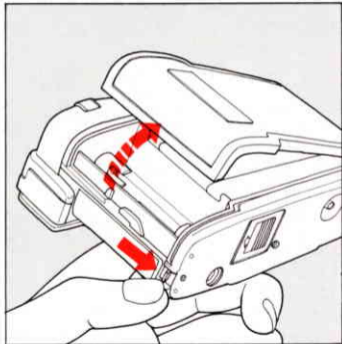

5.

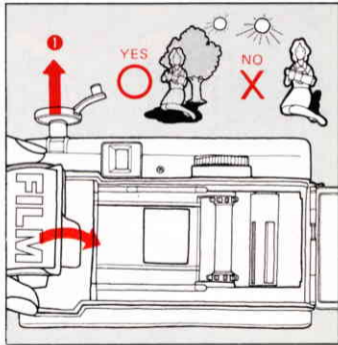

6.

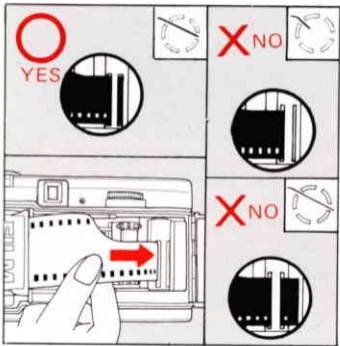

7.

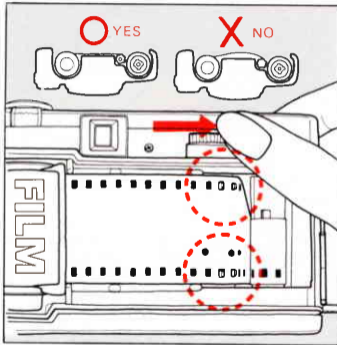

8.

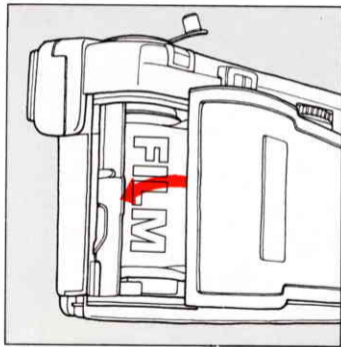

9.

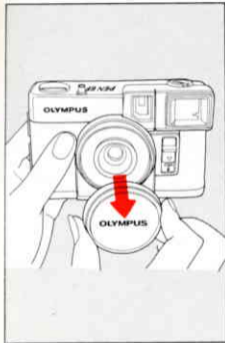

10.

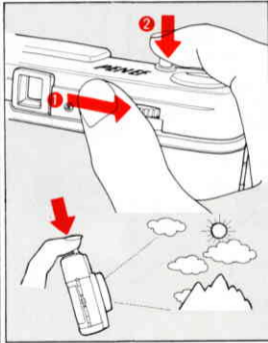

11.

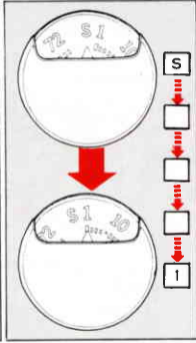

12.

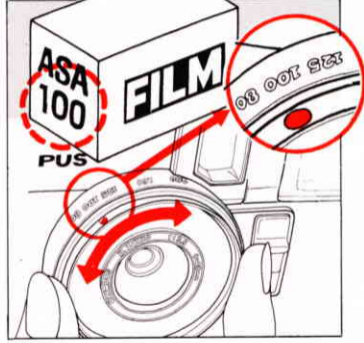



1.

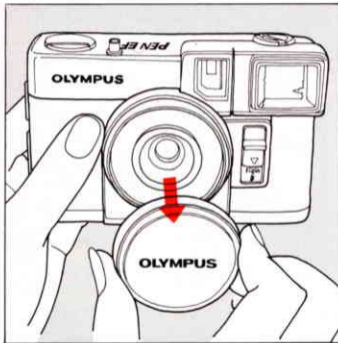

2.



3.



4.

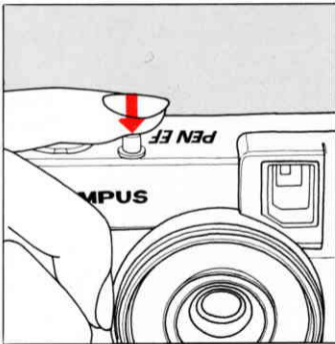

5.

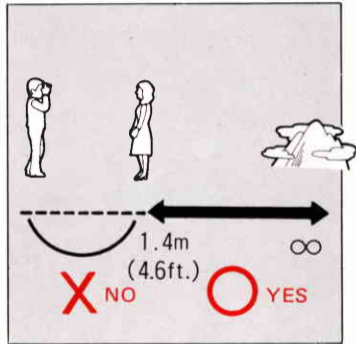





1.

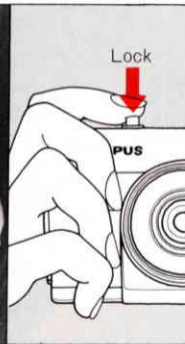

2.

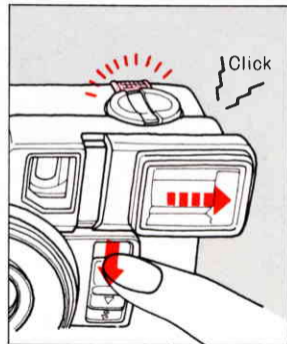

3.

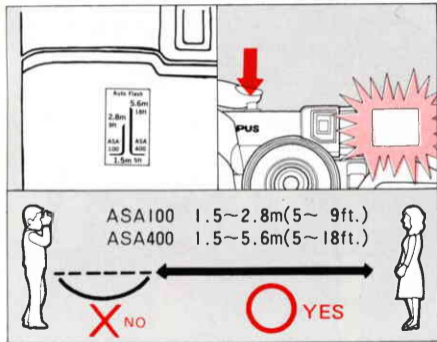

4.



5.

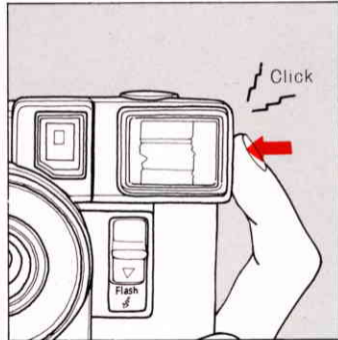

1.

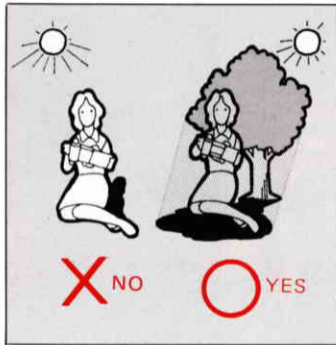

2.

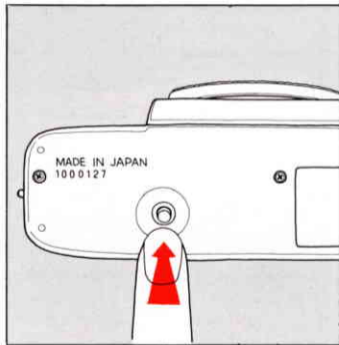

3.

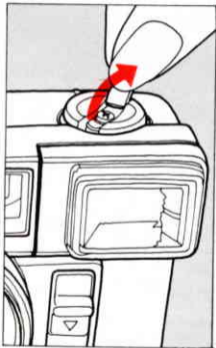

4.

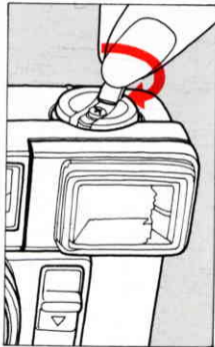

5.

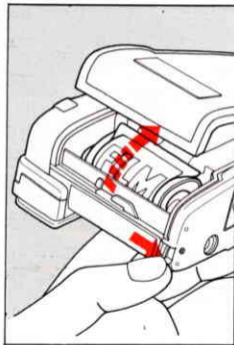

6.

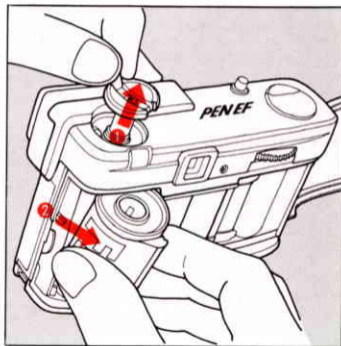

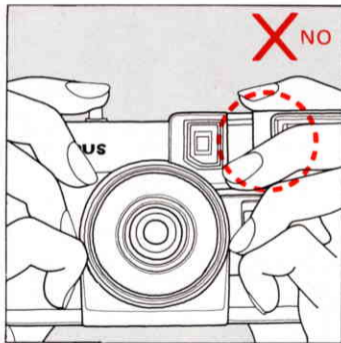
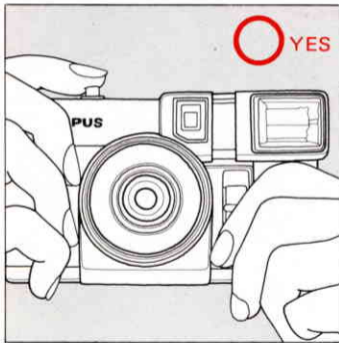

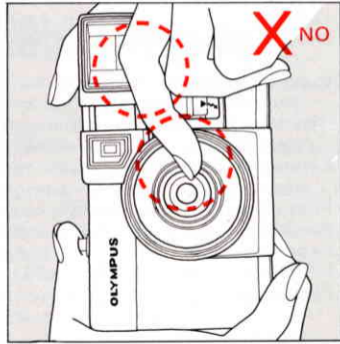
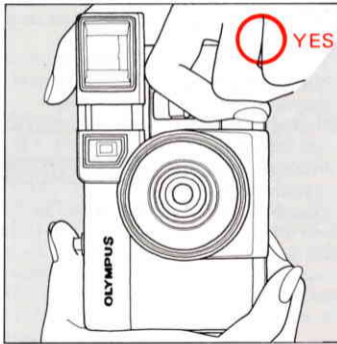
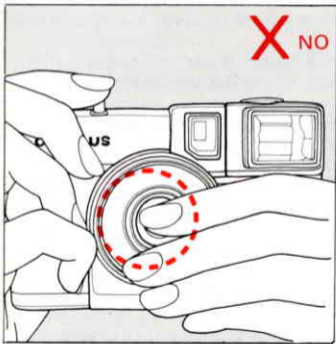

## MAIN SPECIFICATIONS

**Camera type:** 35mm Pen-size lens-shutter camera.

**Film format:** 24 x 18 mm (Pen size).

**Lens:** D. Zuiko 28 mm F3.5, 4 elements in 3 groups.

**Shutter:** Programmed lens shutter (F3.5•1/30 sec. ~ F22•1/250 sec.)

**Exposure control:** Automatic by built-in EE meter. Shutter release lock against under-exposure.

**Viewfinder:** Bright frame finder, 0.5X. Red warning signal against under-exposure.

**Exposure counter:** Progressive type with automatic reset.

**Film rewind:** Crank type with rewind release button.

**Focusing:** Fixed focus (1.4 m or 4.6 ft. ~ ∞).

**Exposure range:** EV 8.5 ~ 17 (ASA 100).

**Film speed range:** ASA 25 ~ 400.

**Film advance:** Rear winding thumbwheel (180°). Built-in prevention against double advance and double exposure.

www.orphancameras.com

**Flash:** Built-in automatic electronic flash. GN 10 (ASA 100, meters) or 33 (ASA 100, feet) with one 1.5V AA 'penlight' battery (including Ni-Cd). Recycling time approx. 7 sec. and approx. 150 flashes with AA alkaline battery. X contact, 1/30 sec.

**Filter size:** 43.5 mm screw-in.

**Dimensions:** 115(W) x 74(H) x 44(D) mm. (4.5 x 2.9 x 1.7 in.)

**Weight:** 280 grams or 9.9 oz. (less battery).

## HAUPTDATEN

**Kamera-Typ:** 35 mm Objektivverschlußkamera.

**Filmformat:** 24 x 18 mm Halbformat (Pen-Size).

**Objektiv:** D. Zuiko 28 mm F3.5, 4 Elemente in 3 Gruppen.

**Verschluß:** Programmverschluß (F3,5•1/30 Sek. ~ F22•1/250 Sek.)

**Belichtungskontrolle:** Automatisch mit eingebautem

EE Meter. Verschluß-auslösersperre gegen un-

genügend Licht.

**Sucher:** Leuchtrahmensucher, 0,5X. Rotes Warnsignal gegen ungenügend Licht.

**Zählwerk:** Vorwärtzzählend mit automatischer Rückstellung.

**Filmrückspulung:** Mit ausklappbarer Rückspulkurbel.

**Scharfeinstellung:** Konstante Brennweite (1.4 m ~  $\infty$ ).

**Belichtungsbereich:** EV 8.5 ~ 17 (ASA 100).

**Filmempfindlichkeitsbereich:** 15 ~ 27 DIN (ASA 25 ~ 400).

**Filmtransport:** Mit Daumenreibrad (180°). Eingebaute Verhütung gegen Doppel-Transport und Doppel-Belichtung.

**Blitz:** Eingebauter automatischer Elektronenblitz. Leitzahl 10 (ASA 100, Meter) mit einer 1.5V AA "Penlight" Batterie (inkl. Ni-Cd). Blitzfolgezeit ca. 7 Sek. und ca. 150 Blitze mit AA Alkalin Batterie. X Kontakt, 1/30 Sek.

www.orphancamera.com Filtergröße: 43.5 mm schraubbar.

Maße: 115 x 74 x 44 mm.

Gewicht: 280 Gramm (ohne Batterien).

## CARACTERISTIQUES PRINCIPALES

**Modèle:** Appareil 35 mm avec l'obturateur à derrière l'objectif.

**Format du film:** 24 x 18 mm (Format Pen).

**Objectif:** D. Zuiko 28 mm F3.5 - 4 lentilles en 3 groupes.

**Obturateur:** Obturateur à deux programmé (F3,5-1/30 sec. ~ F22-1/250 sec.).

**Contrôle d'exposition:** Automatique par "œil électrique" incorporé. Verrouillage de l'obturateur en cas de lumière insuffisante.

**Viseur:** Cadre lumineux, 0,5X. Signal rouge en cas de lumière insuffisante.



**Compteur d'image:** Type progressif avec [www.orpho.com](http://www.orpho.com) [www.pancameras.com](http://www.pancameras.com)  
automatique.

**Rebobinage du film:** Par manivelle, avec bouton de débrayage.

**Mise au point:** Mise au point fixe (1,4 m ~ ∞).

**Gamme d'exposition:** I.L. 8,5 ~ 17 (100 ASA).

**Echelle de sensibilité de films:** 25 ASA ~ 400 ASA.

**Avancement du film:** Par molette arrière (180°). Dispositif de prévention contre double avance et double exposition.

**Montage du flash:** Flash électronique automatique incorporé. Nombre guide 10 (100 ASA, m) avec une pile 1,5V AA "Baton" (Ni-Cd inclus). Temps recharge environ 7 secondes et environ 150 eclairs avec une pile alkaline AA. La prise de synchronisation X, 1/30 sec.

**Diametre de filtre:** 43,5 mm (à vis).

**Dimensions:** 115 x 74 x 44 mm.

**Poids:** 280 gr. (sans pile).

## ESPECIFICACIONES PRINCIPALES

**Tipo de cámara:** Cámara de 35 mm de obturador en el objetivo.

**Formato de la película:** 24 x 18 mm (tamaño Pen).

**Objetivo:** D. Zuiko 28 mm f3,5, 4 elementos en 3 grupos.

**Obturador:** Obturador programado (f3,5 • 1/30 seg. ~ f22 • 1/250 seg.)

**Control de la exposición:** Automático por "ojo fotoeléctrico" incorporado. Bloqueo del disparador del obturador con luz insuficiente.

**Visor:** Visor luminoso de 0,5X. Señal roja de subexposición.

**Cuenta exposiciones:** Progresivo. Reposición automática.

**Rebobinado de la película:** Tipo manivela con botón de seguro.

**Enfoque:** Enfoque fijo (1,4 m ~ ∞).

**Gama de exposiciones:** EV 8,5 ~ 17 (ASA 100).

**Sensibilidad de la película:** ASA 25 - 400.

**Avance de la película:** Corona de bobinado en la parte posterior (180° de giro). Dispositivo prevención incorporado contra doble avance y doble exposición.

**Flash:** Flash electrónico automático incorporado. Número guía 10 (ASA 100, metros) con una pila de 1,5V tamaño AA (incluyendo Ni-Cd). Tiempo de recuperación... aprox. 7 seg. y aprox. 150 destellos con pilas alcalinas de tamaño AA. Zapata X, 1/30 seg.

**Tamaño del filtro:** 43,5 mm, de rosca.

**Dimensiones:** 115 x 74 x 44 mm.

**Peso:** 280 gr. sin pilas.

## ESPECIFICACOES PRINCIPAIS

**Tipo de máquina:** Máquina 35 mm com obturador-lente.

**Formato do filme:** 24 x 18 mm (tamanho Pen).

**Lentes:** D. Zuiko 28 mm F3.5, 4 elementos em 3 grupos.

**Obturador:** Obturador automático de lentes traseiras (F3.5•1/30 seg. ~ F22•1/250 seg.)

**Controle de exposição:** Automatizado pelo medidor EE embutido. Disparador trava com exposição não adequada.

**Visor:** Quadro de visor claro, 0.5X, sinal vermelho indicador de exposição não adequada.

**Contador de exposição:** Tipo progressivo com reacer-to automático.

**Rebobinador de filme:** Tipo manivela com botão de obturador do rebobinador.

**Enfocção:** Foco fixo (1.4 m ~ ∞).

**Distância de exposição:** EV 8.5 – 17 (ASA 100). [www.orphanocameras.com](http://www.orphanocameras.com)

**Distância em velocidade do filme:** ASA 25 ~ 400.

**Avanço do filme:** Levantar (180°) a alavanca do enrolador. Prevenção embutida para avanço duplo e exposição dupla.

**Flash:** Flash eletrônico automático e embutido. GN 10 (ASA 100, metros) com um 1.5V AA bateria "penlight" (incluindo Ni-Cd). Tempo de reciclagem ... aprox. 7 seg. e aprox. 150 flashes com bateria AA alcalina. Contacto X, 1/30 seg.

**Tamanho do filtro:** 43.5 mm atarraxável.

**Dimensões:** 115(W) x 74(H) x 44(D) mm.

**Peso:** 280 gramas (sem a bateria).

